

# CRUZETA DE FLANGE MÓVEL

## MOVABLE FLANGED CROSSHEAD

11.2300

PN 10 / 16

construção seg.  
according to

EN 598

Flange

DIN EN 1092-2

Os acessórios flangeados para águas residuais da Fucoli-Somepal possuem marcação CE segundo a norma EN 598 anexo ZA.

The flanged fittings for sewerage applications from Fucoli-Somepal have CE mark in accordance with standard EN 598 annex ZA.

A partir de DN 700 inclusive as cruzetas são de flange fixa.  
From DN 700 inclusively the crossheads are with fixed flanges.

componente	material	component	material	norma	standard
corpo e flanges	ferro fundido dúctil (EN-GJS-500)	body and flanges	ductile iron (EN-GJS-500)	DIN EN 1563	
revestimento anticorrosivo interior e exterior	tinta epóxica para águas residuais RESICOAT R4 - ES - RED BROWN aplicada electrostaticamente com espessura $\geq 250 \mu\text{m}$	coating inside and outside	epoxy paint for residual water RESICOAT R4 - ES - RED BROWN applied electrostatically with thickness $\geq 250 \mu\text{m}$	DIN 30677	

Sob Consulta:  
Outros diâmetros.

On request:  
Other diameters.

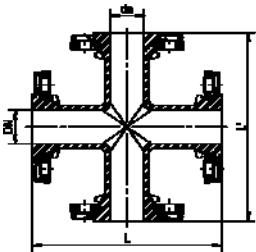

DN	dn	Código - Code		L	L'	Peso - Weight (Kg)	
		PN 10	PN 16			PN 10	PN 16
40	40	10080016	10080016	255	255	11.0	11.0
50	50	10080018	10080018	280	280	12.5	12.5
60	50	10080020	10080020	305	300	14.0	14.0
	60	10080021	10080021	305	305	14.2	14.2
65	50	10080023	10080023	305	300	14.0	14.0
	60	10080024	10080024	305	305	15.0	15.0
	65	10080025	10080025	305	305	15.6	15.6
80	50	10080027	10080027	310	310	15.5	15.5
	60	10080028	10080028	310	310	16.5	16.5
	65	10080029	10080029	310	310	16.5	16.5
	80	10080030	10080030	330	330	18.0	18.0
100	50	10080032	10080032	320	330	19.0	19.0
	60	10080033	10080033	320	330	20.0	20.0
	65	10080034	10080034	320	330	20.0	20.0
	80	10080035	10080035	330	340	20.3	20.3
	100	10080040	10080040	360	360	23.0	23.0



11.2300

# CRUZETA DE FLANGE MÓVEL

## MOVABLE FLANGED CROSSHEAD

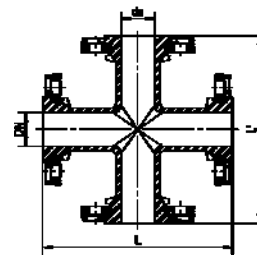

DN	dn	Código - Code		L	L'	Peso - Weight (Kg)	
		PN 10	PN 16			PN 10	PN 16
125	80	10080045	10080045	350	370	27.0	27.0
	100	10080046	10080046	370	390	29.0	29.0
	125	10080047	10080047	400	400	30.2	30.2
150	80	10080052	10080052	360	400	29.0	29.0
	100	10080053	10080053	380	410	30.0	30.0
	150	10080055	10080055	440	440	36.5	36.5
175	175	10080056	10080056	480	480	46.2	46.2
200	100	10080061	10080061	400	460	37.8	37.8
	150	10080063	10080063	460	490	47.0	47.0
	200	10080064	10080064	520	520	55.0	55.0
250	100	10080075	10080076	425	540	50.0	50.0
	150	10080079	10080080	485	560	61.0	61.0
	200	10080081	10080082	540	580	71.0	71.0
	250	10080083	10080084	600	600	84.1	84.1
300	100	10080095	10080096	450	600	69.0	69.0
	125	10080097	10080098	505	620	76.0	76.0
	150	10080099	10080100	505	620	83.0	83.0
	200	10080101	10080102	565	640	94.0	94.0
	250	10080103	10080104	620	660	108.0	108.0
	300	10080105	10080106	680	680	117.0	117.0
350	350	10080129	10080130	760	760	158.0	165.6
400	400	10080155	10080156	840	840	203.0	211.0
450	450	10080157	10080158	920	920	249.0	267.0
500	500	10080183	10080184	1000	1000	295.0	331.0
600	600	10080213	10080214	1165	1165	437.0	477.0
700	700	10109450	10109451	1200	1200	625.0	
800	800	10109460	10109461	1350	1350		
900	900	10109470	10109471	1500	1500		
1000	1000	10109480	10109481	1650	1650		



### Homologações - Homologation

**Revestimento** - Coating

- **KIWA** (Holanda - Netherlands)
- **WRAS** (Reino Unido - United Kingdom)
- **CARSO** (França - France)
- **STÁTNI ZDRAVOTNÍ ÚSTAV** (República Checa - Czech Republic)

Sendo um dos principais objectivos da nossa empresa o desenvolvimento e aperfeiçoamento dos nossos produtos, reservamo-nos no direito de fornecer quaisquer outros que possam diferir ligeiramente dos descritos e ilustrados nesta publicação.

Being one of our aims a constant development of our products, the characteristics of described material may be altered without prior warning.