

# PORTINHOLAS LID

15.100

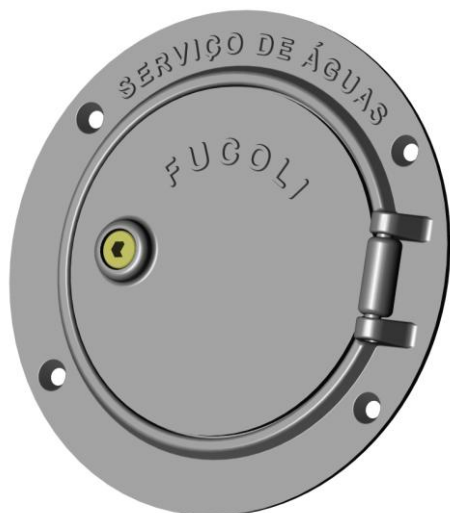

**Modelo:** “Redonda”, “Oval” e “Rectangular”

**Material:** Ferro Fundido Dúctil  
(EN-GJS-500-7)

**Model:** “Round”, “Oval” and “Rectangular”

**Material:** Ductile Iron  
(EN-GJS-500-7)

**DIN EN 1563**

**Pintura preta de base aquosa.**  
Water based black painting.

**Opcionalmente poderá ser personalizado.**  
Optionately could be personalized .

**Fecho: Sextavado interior de 6mm.**  
Lock: Hexagon socket 6mm.

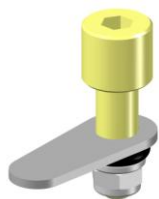

**Pormenor do Fecho**  
Lock Detail

Código Code	Modelo Model	Dimensões máximas Greatest dimension mm	Encastramento Inlay mm	Peso Weight (Kg)
10603110	Redonda	Ø200	154x137	1.9
10605010	Oval	360x220	305x182	4.4
10609110	Rectangular	464x310	408x274	10.5



**Redonda**



**Oval**



**Rectangular**